

Jiaxing Cavort Hardware Co., Ltd Reserve The Copyright of The Brochure. we Have Checked The Contents And All Photo Carefully , And we Are Free From Any Responsibilities In Case of Any Error By The Mistranlation of The Limited of Our English The Limited of Our English Ability . We Reserve The Rights To The Changes of The Products Designs That You Might Not Be Informed



CAVORT
HARDWARE SYSTEMS

卡沃德五金
CAVORT HARDWARE

CE CERTIFICATE NO.CPR-J-00921-19
CPR-J-01030-19

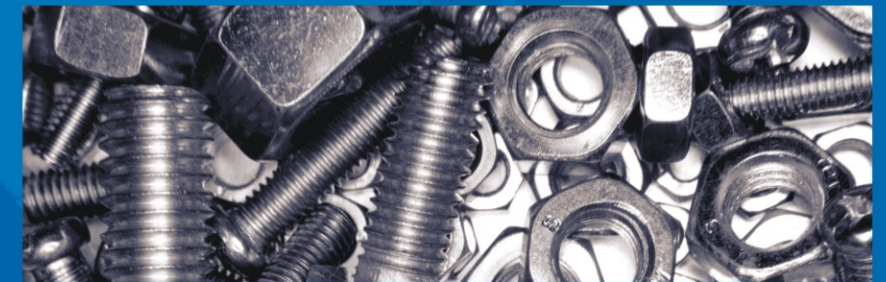
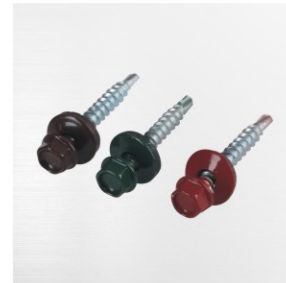
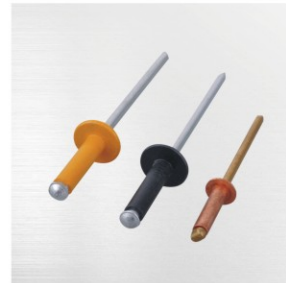
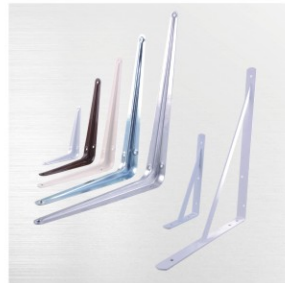

CAVORT HARDWARE
卡沃德五金

JIAXING CAVORT HARDWARE CO.,LTD
Add:Room1-1203 Bojinwan Plaza,No.616 West Zhonghuan Road,Jiaxing City
Zhejiang Province,China
Tel:+86-573-82646333/+86-15988314633
Fax:+86-573-82648555
E-mail:g_export@nbcavort.com
嘉兴卡沃德五金有限公司
地址：浙江省嘉兴市中环西路616号泊金湾广场1-1203室
邮编(P.C):314000

CATALOG PRODUCT

[Http://www.nbcavort.com](http://www.nbcavort.com)



C 公司简介 COMPANY BRIEF

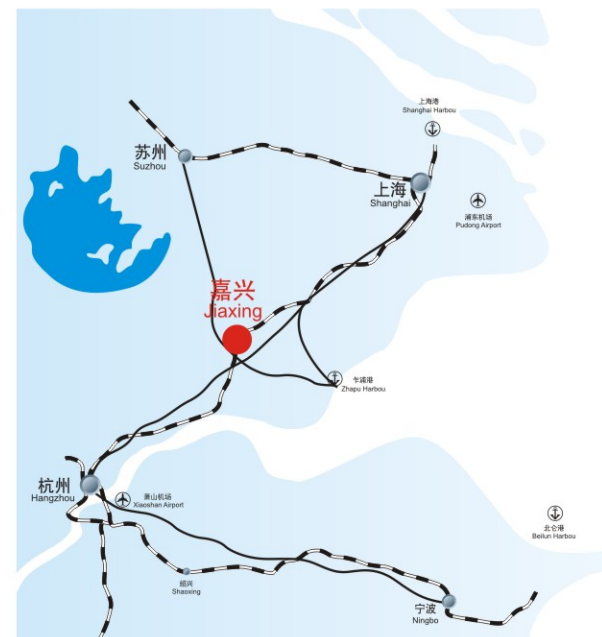

CAVORT COMPANY was founded in 2008 from NingBo China; We moved to Jiaxing City in 2014 with requests of change and development. JiaXing is in the middle from ShangHai to HangZhou, it takes a facility traffic way by Train and Air all over China.

We are reputed for high quality manufacturing to meet hardware and fasteners demand overseas. Our product ranges from standard fasteners to customized special, developing per customer's request. The regular range of products are series of Tapping/Drilling Screws including such as Din7504K,P,N, Chipboard and Drywall Screws, Lag Screws and so on, different types of Bolts, Nuts, Washers, Anchor,

Riggings, Furniture hardware and fittings, Main Class we provide 4.8, 5.8, 8.8, 10.9.

Company structured with Purchase Dept, Sales Office, QC Office, Logistic Dept and, Finance Accounting Office; each team individual existence but hold to work together tightly to Custom's requests and taken responsibility and duties for what each one do..

We have our own manufacturer of Self Drilling Screws, that is saying we make different type of drilling screws ourselves, besides we trade and deal with other fasteners and hardware parts; We cooperated with 500 brother factories to provide competitive and stable quality product, our QC office check and control each shipment and keep real samples for tracking record.

Our concerning is to provide special package service by customers' demand, collecting different hardware products according to buyers' target, and to provide cost-saving and high-quality products as well convenient work to our clients worldwide. Collecting from 10 year's experience, we have full confidence to provide you excellent service and we guarantee to you:

- 1 > Quality Products
- 2 > Reasonable Price
- 3 > Timely Delivery
- 4 > Quick Response to Buyer's Request



CONTENTS



DRILLING SCREWS

Hex Flanged Head Self Drilling Screw With EPDM Sealing Washer

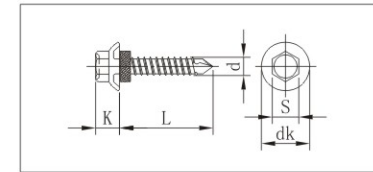

Specification	#12-14×3/4"
	#12-14×1"
	#12-14×1 1/4"
	#12-14×2"

Hex Cupped Flange Head, Self Drilling Screw, Double Thread, With Assembled EPDM Sealing Washer, Yellow Zinc Plated (Sandwich Panel Screw)

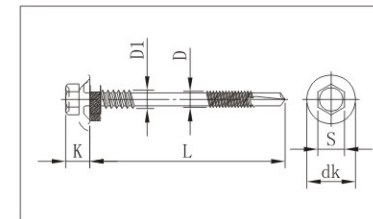

Specification	#12-14/14-14×2 3/4"
	#12-14/14-14×3 1/4"
	#12-14/14-14×3 1/2"
	#12-14/14-14×4"
	#12-14/14-14×5"

Self Drilling Screws, Phillips #2 Flat Head With Wings, Dacrotized
Self Drilling Screws, Phillips, Flat Head With Wings, Zinc

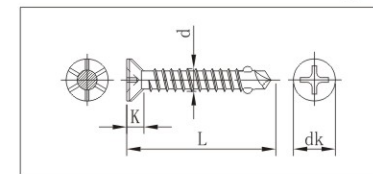

Specification	Specification
#12-14×1 3/4"	#12-14×2 1/4"
#12-14×1 1/2"	#12-14×2 1/2"
#12-14×2"	#12-14×3"

Hex Washer Head Self Drilling Screw With EPDM Washer, #2, Zinc Plated/Painted

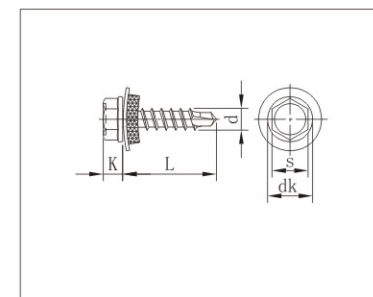

Specification	Specification
4.8×19	4.8×41
4.8×25	4.8×50
4.8×29	4.8×63
4.8×32	4.8×70
4.8×35	4.8×76
4.8×38	4.8×80

Roofing Screw With EPDM Washer, 16mm PT5 Drilling Point, Strips On Body

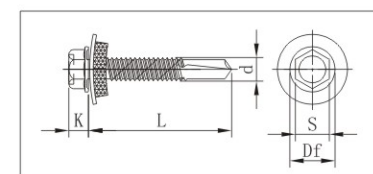

Specification	Specification
5.5×25	5.5×60
5.5×32	5.5×70
5.5×38	5.5×80
5.5×51	5.5×90

DRILLING SCREWS

Pan Head Phillips Self-Drilling Screws (DIN7504-N)

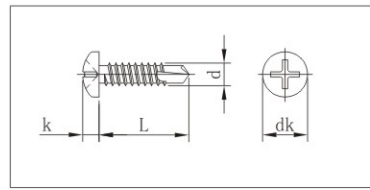

d	dk	k	L
3.5	6.9	2.6	13-55
3.9	7.5	2.8	13-65
4.2	8.2	3.05	13-100
4.8	9.5	3.55	13-100
5.5	10.8	3.95	13-100
6.3	12.5	4.55	13-100

Countersunk Head Phillips Self-Drilling Screws (DIN7504-P)

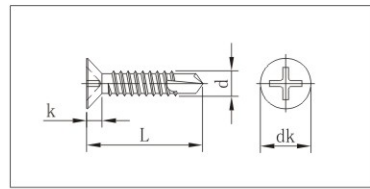

d	dk	k	L
3.5	6.8	2.1	13-55
3.9	7.5	2.3	13-60
4.2	8.1	2.5	13-75
4.8	9.5	3.0	13-100
5.5	10.8	3.4	16-100
6.3	12.4	3.8	16-100

Hexagonal Washer Head Self-Drilling Screws (DIN7504-K)

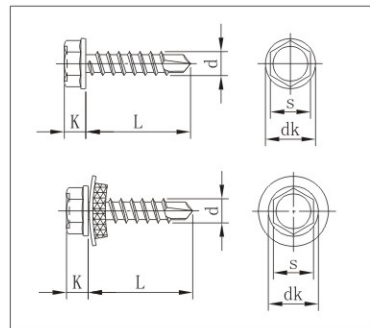

d	dk	s	K	L
3.5	8.3	5.5	3.4	13-51
3.9	8.3	5.5	3.8	13-80
4.2	8.8	7.0	4.0	13-100
4.8	10.5	8.0	4.3	13-100
5.5	11.0	8.0	5.3	19-130
6.3	13.2	10.0	6.3	19-200

Raised Countersunk Head Tapping Screws With Slot (DIN7973)

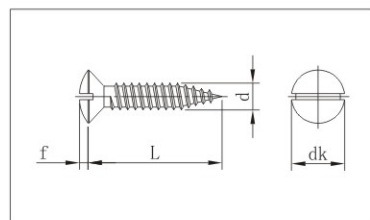

d	dk	f	L
3.5	6.8	1.2	6.5-50
3.9	7.5	1.3	9.5-50
4.2	8.1	1.4	9.5-50
4.8	9.5	1.5	9.5-63
5.5	10.8	1.7	13-75
6.3	12.4	2.0	13-75

Pan Head Tapping Screws With Slot (DIN7971)

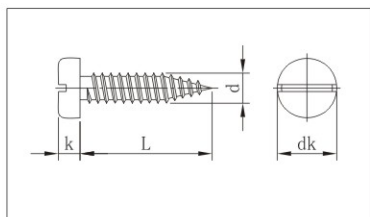

d	dk	K	L
3.5	6.9	1.85	6.5-50
3.9	7.5	2.00	9.5-50
4.2	8.2	2.15	9.5-50
4.8	9.5	2.50	9.5-63
5.5	10.8	2.85	13-75
6.3	12.5	3.20	13-75

TAPPING SCREWS

Countersunk Head Tapping Screws With Slot (DIN7972)

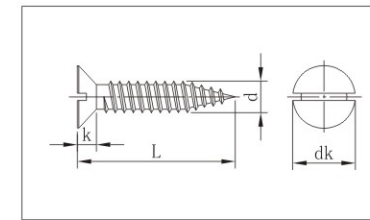

d	dk	K	L
3.5	6.8	2.10	6.5-50
3.9	7.5	2.30	9.5-50
4.2	8.1	2.50	9.5-50
4.8	9.5	3.00	9.5-63
5.5	10.8	3.40	13-75
6.3	12.4	3.80	13-75

Cross Recessed Pan Head Tapping Screws (DIN7981)

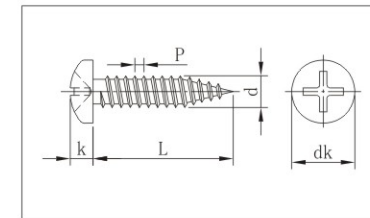

d	dk	K	L
3.5	6.9	2.60	6.5-50
3.9	7.5	2.80	9.5-50
4.2	8.2	3.05	9.5-50
4.8	9.5	3.55	9.5-63
5.5	10.8	3.95	13-75
6.3	12.5	4.55	13-75

Cross Recessed Countersunk Head Tapping Screws (DIN7982)

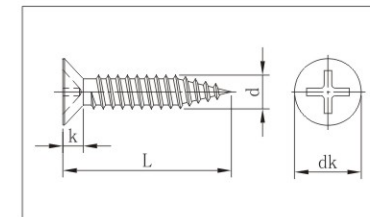

d	dk	f	L
3.5	6.8	2.1	6.5-50
3.9	7.5	2.3	9.5-50
4.2	8.1	2.5	9.5-50
4.8	9.5	3.0	9.5-63
5.5	10.8	3.4	13-75
6.3	12.4	3.8	13-75

Cross Recessed Countersunk Head Wood Screws (DIN7997)

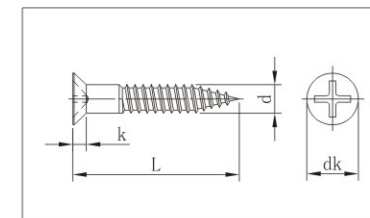

d	dk	K	L
3.0	5.6	1.65	10-40
3.5	6.5	1.93	12-50
4.0	7.5	2.20	12-70
4.5	8.3	2.35	16-70
5.0	9.2	2.50	16-100
6.0	11.0	3.00	20-140

Hexagonal Head Wood Screws (DIN571)

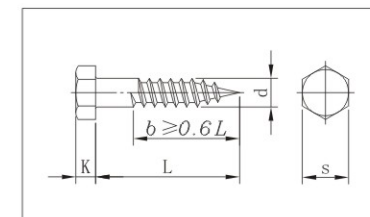

d	k	S	L
5	3.5	8	20-100
6	4.0	10	25-150
8	5.5	13	20-300
10	7	17	30-400
12	8	19	45-400
16	10	24	50-460

Chipboard Screws

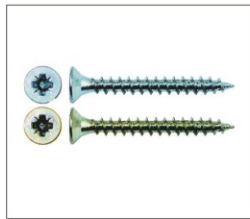
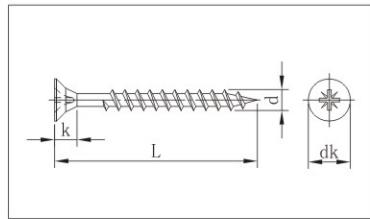

d	dk	K	L
3.0	6	3.2	12-50
3.5	7	3.6	12-70
4.0	8	4.25	12-90
4.5	9	4.60	16-100
5.0	10	5.2	20-120
6.0	12	6.2	20-220

Modified truss head self-Drilling / Tapping Screw / k-Lath

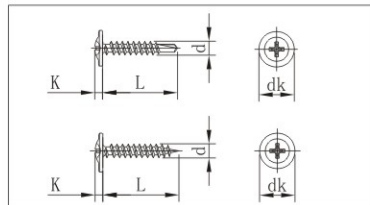

d	dk	k	L
4.2	10.6-11.2	2.5	13-75

Pan Framing head / Fillister Head Self-Tapping/Drilling Screw

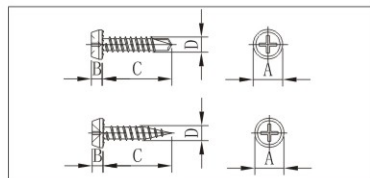

Specification	Specification
3.5×9.5	3.9×9.5
3.5×11	3.9×11

Sandwich Panels Screw, 16mm PT5 Drilling Point

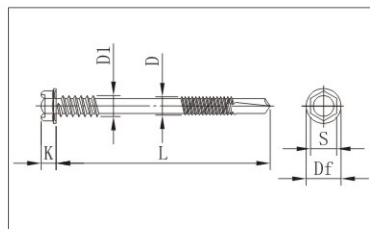

Specification	Specification
6.3/5.5×75	6.3/5.5×155
6.3/5.5×90	6.3/5.5×160
6.3/5.5×100	6.3/5.5×185
6.3/5.5×105	6.3/5.5×205
6.3/5.5×120	6.3/5.5×240
6.3/5.5×135	6.3/5.5×280

Self-Drilling / Tapping Window Screw

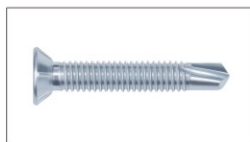
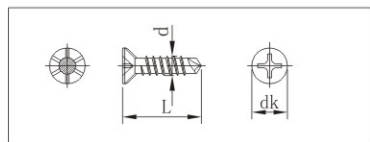

Specification	Specification	Specification
3.9×13	3.9×25	3.9×41
3.9×16	3.9×32	3.9×45
3.9×19	3.9×35	3.9×50
3.9×22	3.9×38	3.9×60

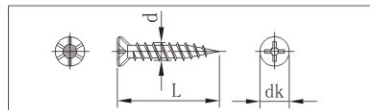

Specification	Specification	Specification
4.0×16	4.0×30	4.0×45
4.0×20	4.0×35	4.0×50
4.0×25	4.0×40	



Hex Washer Head Self Tapping Screw With PVC Washer

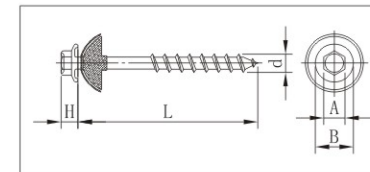

Specification	Specification
	5/16" × 110
	5/16" × 130

Hex Flanged Head self Tapping Screw High-Low Thread, Type 17.With EPDM Sealing Washer

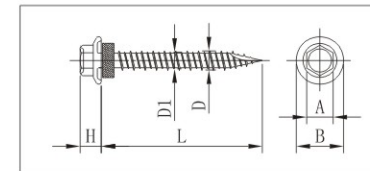

Specification	Specification
#10 × 1"	#10 × 2 1/2"
#10 × 1 1/2"	#10 × 2 3/4"
#10 × 1 3/4"	#10 × 3"
#10 × 2"	

Confirmat Screws

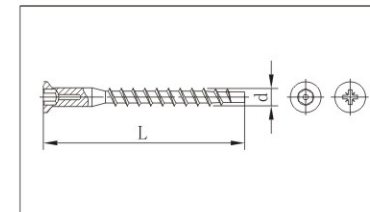

d	d	L
5.0×40	5.0	40
5.0×50	5.0	50
6.4×50	6.4	50
7.0×40	7.0	40
7.0×50	7.0	50
7.0×70	7.0	70

Wood Building Screws Double Flat Head Torx Drive With 6Nibs &Cutting Point Type "17" On Shank

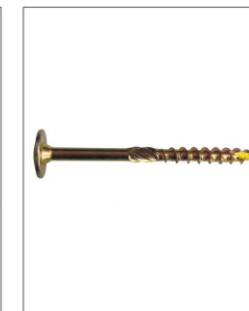
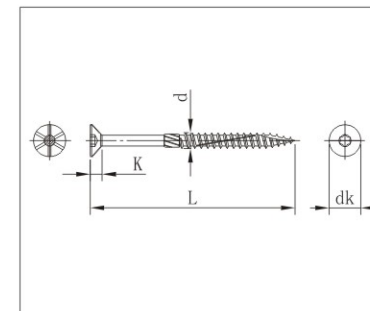

Specification	Specification	Specification
6×60	6×200	8×200
6×80	6×220	8×230
6×100	6×240	8×260
6×120	6×260	8×300
6×130	8×100	10×180
6×140	8×120	10×200
6×150	8×140	10×260
6×160	8×160	10×280
6×180	8×180	10×300

TAPPING SCREWS

Hanger Bolts With Wood & Metric Thread

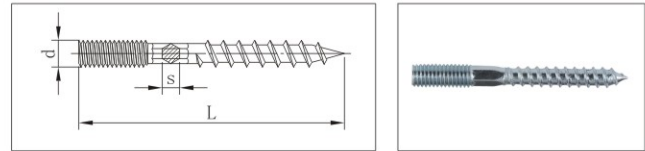

Size	S	L
M6	5	60-150
M8	6	50-250
M10	8	50-250

Pozi Countersunk Head Nail Screws

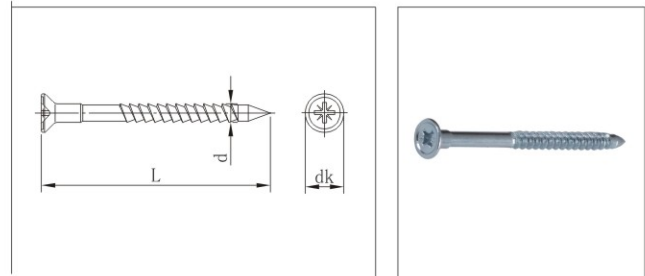

Specification	Specification	Specification
3.5×30	3.8×84	4.8×102
3.5×35	4.8×63	4.8×122
3.5×40	4.8×83	4.8×142
3.5×45	4.8×103	4.8×64
3.5×50	4.8×123	4.8×84
3.5×55	4.8×47	4.8×105
3.8×38	4.8×62	4.8×125
3.8×45	4.8×77	4.8×145
3.8×64	4.8×82	4.8×165

Nail Screws

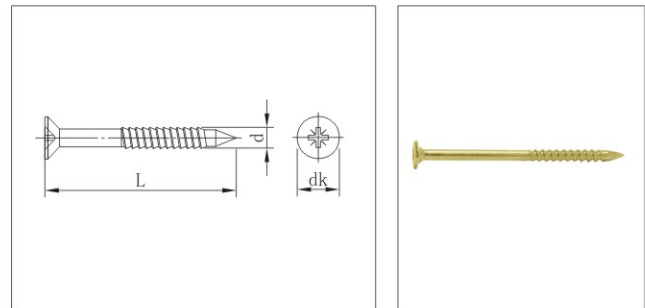

Size	d	dk	L
4×38	4	7.5	38
4×43	4	7.5	43
4×63	4	7.5	63
4×83	4	7.5	83
5×63	5	10.2	63
5×83	5	10.2	83
5×103	5	10.2	103
5×123	5	10.2	123
5×143	5	10.2	143

Phillips Washer Head Self-Tapping Screw



d	dk	L
4.2	10.6 - 11.2	13 - 75

Flat Countersunk Head Hi-Low Thread Self-Tapping Screw

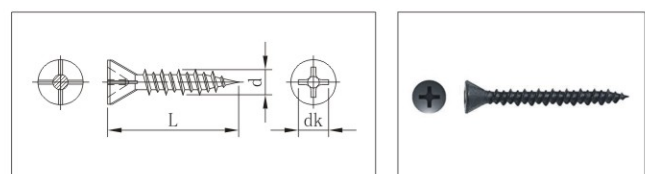

Specification	Specification	Specification
3.9×19	3.9×25	3.9×35
3.9×22	3.9×30	3.9×45

TAPPING SCREWS

Drywall Screws (Fine Thread / Coarse Thread)



d	dk	L
3.5	7.9-8.5	16-55
3.9	7.9-8.5	65-70
4.2	7.9-8.5	65-102
4.8	8.8-9.4	90-152

Phillips Bugle Head Drywall Screw With Drilling Point

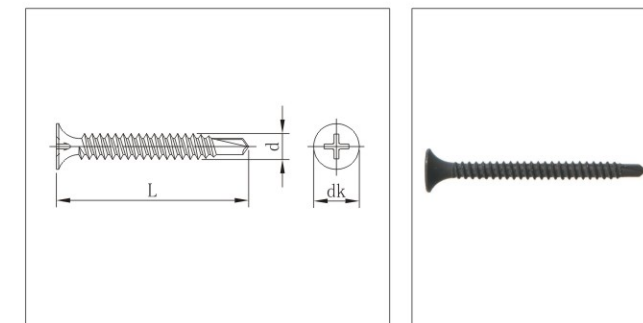

Specification	Specification	Specification
3.5×13	3.5×42	#6-20×1"
3.5×16	3.5×45	#6-20×1 3/8"
3.5×19	3.5×51	#6-20×1 3/4"
3.5×25	3.5×55	#6-20×2 1/4"
3.5×28	3.5×64	#8-18×1 3/8"
3.5×32	3.5×76	#8-18×1 3/4"
3.5×35	4.2×76	#8-18×2 1/4"

Square Hook Wood Screws

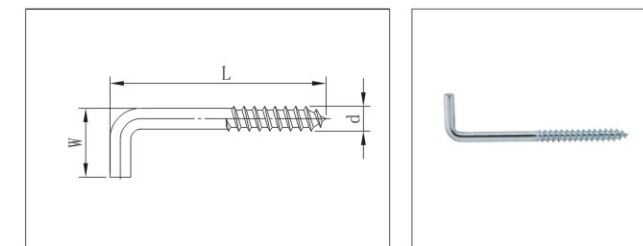

Specification	Specification	Specification
3.0×40	5.0×65	6.0×120
3.5×45	5.0×75	6.0×140
4.0×30	6.0×40	8.0×85
4.0×40	6.0×60	8.0×100
4.0×50	6.0×75	8.0×105
4.0×65	6.0×80	10×100
5.0×40	6.0×100	10×140

Stainless Steel Eye Hook Wood Screw/Window Hook Screw



Specification	Specification	Specification
3.5×15	4.0×45	6.0×70
3.5×20	4.0×60	6.0×80
3.5×25	4.0×70	6.0×90
3.5×30	5.0×40	6.0×100
3.5×40	5.0×50	6.0×120
3.5×45	5.0×60	6.0×140
4.0×16	5.0×75	8.0×80
4.0×20	5.0×85	8.0×100
4.0×25	6.0×40	8.0×120
4.0×35	6.0×50	8.0×140
4.0×40	6.0×60	10×100



NUTS

Steel Lock Hexagonal Nuts With Nylon Insert(DIN985)

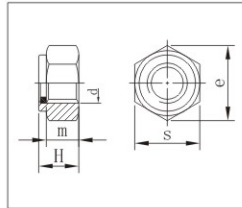

d	H	m	s
M5	5	4.0	8
M6	6	5.0	10
M8	8	6.5	13
M10	10	8.0	17
M12	12	10.0	19
M14	14	11.0	22
M16	16	13.0	24
M20	20	16.0	30

Cap Nuts (DIN1587)

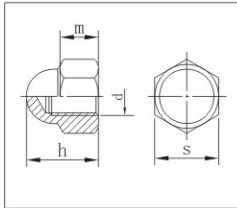

d	h	m max	s
M3	7	2.4	5.5
M4	8	3.2	7
M5	10	4.0	8
M6	12	5.0	10
M8	15	6.5	13
M10	18	8.0	17
M12	22	10	19
M14	25	11	22
M16	28	13	24

Wing Nuts (DIN315)

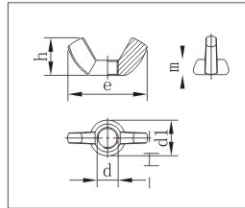

d	d1	e	g	h	m
M4	6	18	1.7	8.5	3.2
M5	8	24	2.3	11	4.0
M6	10	30	2.7	15	5.0
M8	13	36	3.6	18	6.5
M10	17	48	4.6	23	8.0
M12	20	62	5.6	31	10.0
M16	26	70	6.5	35	13.0
M20	32	86	7.0	44	16.0
M24	41	106	8.6	53.5	20.0

Square Nuts (DIN557)

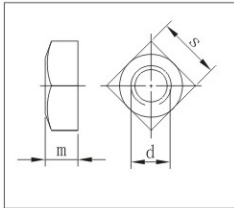

d	s	m
M5	8	4
M6	10	5
M8	13	6.5
M10	16	8
M12	18	10
M16	24	13
M20	30	16

Channel Nuts/ Spring Nuts

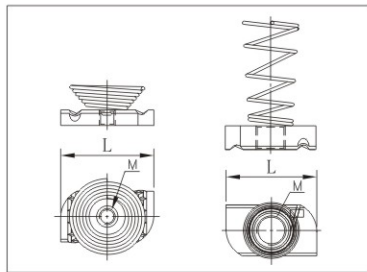

Specification	Specification
1/4"×34.5×19×6	1/2"×34.5×19×9.2
5/16"×34.5×19×6	1/2"×34.5×19×12
3/8"×34.5×19×8	5/8"×34.5×30×11
7/16"×34.5×19×8	3/4"×34.5×30×11
3/8"×34.5×19×9.2	7/8"×34.5×30×11

Machine Screws (DIN965)

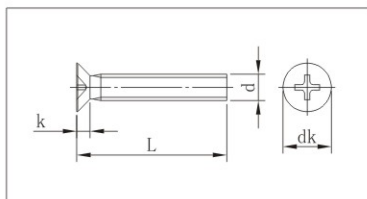

d	dk	K	L
M3	5.6	1.65	3-40
M4	7.5	2.2	4-50
M5	9.2	2.5	6-50
M6	11	3.0	8-50
M8	14.5	4.0	10-55
M10	18	5.0	12-60

NUTS

Hexagonal Nuts (DIN934)

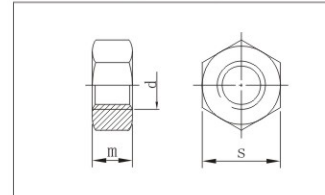

D	S	M
M3	5.5	2.4
M4	7	3.2
M5	8	4.0
M6	10	5.0
M8	13	6.5
M10	17	8.0
M12	19	10.0
M14	22	11.0
M16	24	13.0
M20	30	16.0
M24	36	19.0
M30	46	24.0
M36	55	29.0

Hexagonal Slotted Nuts (DIN935)

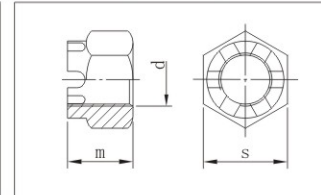

D	S	M
M6	10	7.5
M8	13	9.5
M10	17	12
M12	19	15
M14	22	16
M16	24	19
M18	27	21
M20	30	22
M22	32	26
M24	36	27
M27	41	30
M30	46	33
M33	50	35
M36	55	38

Hexagonal Nuts With Flange (DIN6923)

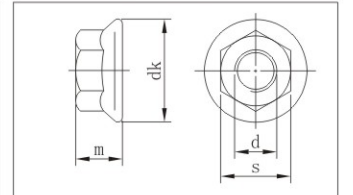

d	s	m	dk
M5	8	5	11.8
M6	10	6	14.2
M8	13	8	17.9
M10	15	10	21.8
M12	18	12	26.0
M14	21	14	29.9
M16	24	16	34.5
M20	30	20	42.8

2H Heavy Duty Nut

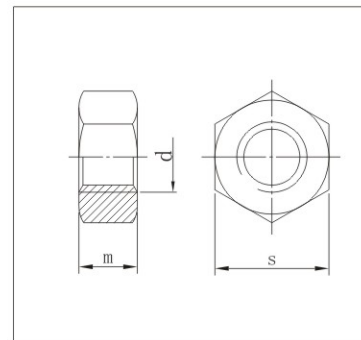

Specification	Specification
1-3/8 UNC	2-3/4-8
1-1/2 UNC	2-1/4-8
1-5/8 UNC	2-1/2-8
1-3/4 UNC	1-7/8-8
1-7/8 UNC	1-3/4-8
2 UNC	1-5/8-8
2-1/4 UNC	1-1/2-8
2-1/2 UNC	1-3/8-8
3-3/4-8	2-8
3-1/2-8	3-8
3-1/4-8	4-8

Machine Screws (DIN7985)

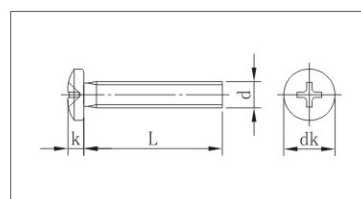

d	dk	K	L
M3	6	2.4	3-40
M4	8	3.1	4-50
M5	10	3.8	6-50
M6	12	4.6	8-50
M8	16	6.0	10-55
M10	20	7.5	12-60

NUTS

BOLTS

Square Nuts (DIN562)

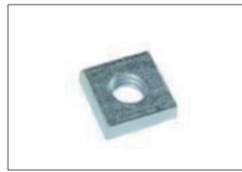
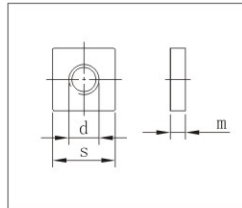

Square Weld Nuts (DIN928)

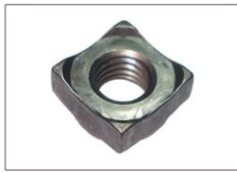
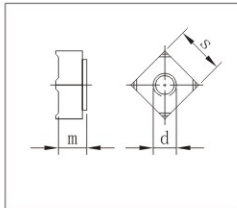

Hexagonal Weld Nuts (DIN929)

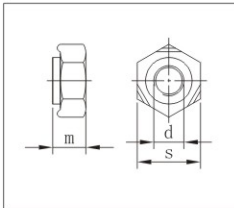

Hexagonal Coupling Nuts (DIN6334)

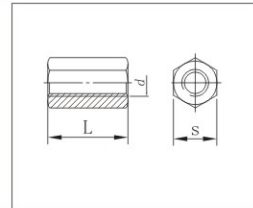

d	s	m
M2	4.0	1.2
M3	5.5	1.8
M4	7.0	2.2
M5	8.0	2.7
M6	10	3.2
M8	13	4.0
M10	17	5.0

d	s	m
M4	7	3.5
M5	9	4.2
M6	10	5.0
M8	14	6.5
M10	17	8.0
M12	19	10.0

d	s	m
M3	7.5	3.0
M4	9	3.5
M5	10	4.0
M6	11	5.0
M8	14	6.5
M10	17	8.0
M12	19	10.0
M14	22	11.0
M16	24	13.0

Size	d	s	L
M6×10×18	M6	10	18
M6×10×20	M6	10	20
M8×13×25	M8	13	25
M8×13×30	M8	13	30
M10×14×30	M10	14	30
M10×17×30	M10	17	30
M12×17×36	M12	17	36
M12×19×36	M12	19	36
M14×19×42	M14	19	42
M16×22×50	M16	22	50
M16×24×48	M16	24	48
M20×24×60	M20	24	60
M20×30×60	M20	30	60
M24×36×50	M24	36	50
M24×36×72	M24	36	72

Thread Rods /B7 Thread Rods

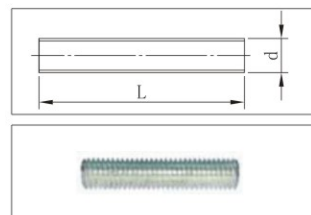

d	M4	M5	M6	M8	M10	M12	M14	M16	M18	
L	1000-4000	1000-4000	1000-4000	1000-4000	1000-4000	1000-4000	1000-4000	1000-4000	1000-4000	
d	M20	M22	M24	M27	M30	M33	M36	M42		
L	1000-4000	1000-4000	1000-4000	1000-4000	1000-4000	1000-4000	1000-4000	1000-4000		
d	1/4"-20	5/16"-18	3/8"-16	7/16"-14	1/2"-13	9/16"-12	5/8"-11	3/4"-10	7/8"-9	1"-8
L	1000-4000	1000-4000	1000-4000	1000-4000	1000-4000	1000-4000	1000-4000	1000-4000	1000-4000	1000-4000

Hexagonal Head Bolts (DIN931) / (DIN960)

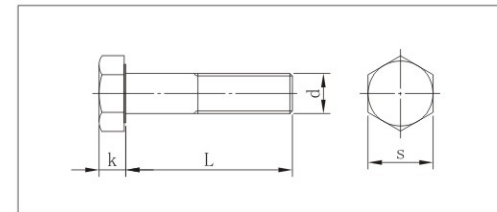

d	K	S	L
M4	2.8	7	25-40
M5	3.5	8	25-50
M6	4.0	10	25-120
M8×1	5.3	13	30-180
M10×1/1.25	6.4	17	40-300
M12×1.25/1.5	7.5	19	40-300
M14×1.5	8.8	22	40-300
M16×1.5	10.0	24	40-300
M18×1.5	11.5	27	45-300
M20×1.5/2	12.5	30	45-300
M22×1.5	14.0	32	45-300
M24×2	15.0	36	45-300
M27×2	17.0	41	70-300
M30×2/3	18.7	46	70-300

Hexagonal Head Bolts (DIN933) / (DIN558)

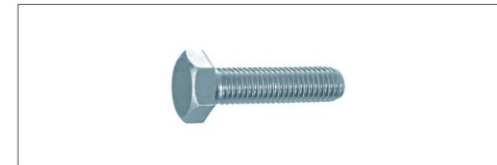
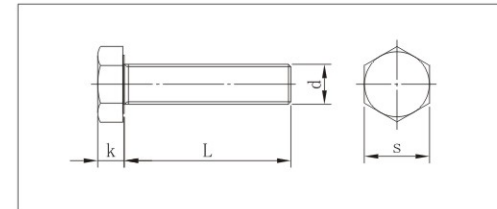

d	K	S	L
M4	2.8	7	25-40
M5	3.5	8	25-50
M6	4.0	10	25-120
M8	5.3	13	30-180
M10	6.4	17	40-300
M12	7.5	19	40-300
M14	8.8	22	40-300
M16	10.0	24	40-300
M18	11.5	27	45-300
M20	12.5	30	45-300
M22	14.0	32	45-300
M24	15.0	36	45-300
M27	17.0	41	70-300
M30	18.7	46	70-300

307A Carriage Bolts

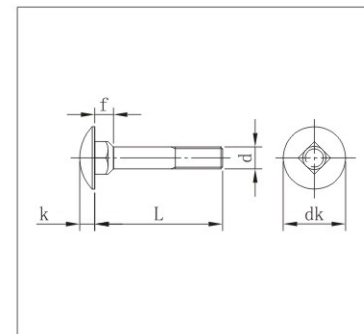

Specification
10×3/4-10×4
1/4×3/4-1/4×8
5/16×3/4-5/16×8
3/8×3/4-3/8×8
7/16×1-7/16×8
1/2×1-1/2×8
5/8×1-5/8×8
3/4×1/2-3/4×8
7/8×1-1/2-7/8×8
1×1-1/2-1×8
1-1/8×2-1/2-1-1/8×8
1-1/4×2-1/2-1-1/4×8
1-3/8×2-1/2-1-3/8×8

METAL WASHERS ,CHAIN

FURNITURE ACCESSORIES

Flat Washers
(DIN125/DIN126)

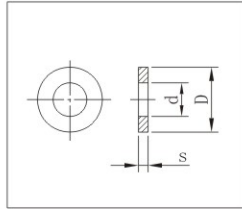

Size	d	D	s
M3	3.2	7	0.5
M4	4.3	9	0.8
M5	5.3	10	1.0
M6	6.4	12	1.6
M8	8.4	16	1.6
M10	10.5	20	2.0
M12	13	24	2.5
M14	15	28	2.5
M16	17	30	3.0
M18	19	34	3.0
M20	21	37	3.0
M22	23	39	3.0
M24	25	44	4.0
M27	28	50	4.0
M30	31	56	4.0
M33	34	60	5.0
M36	37	66	5.0

Flat Washers
(DIN9021)

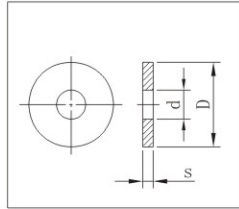

Size	d	D	s
M3	3.2	9	0.8
M4	4.3	12	1.0
M5	5.3	15	1.2
M6	6.4	18	1.6
M8	8.4	24	2.0
M10	10.5	30	2.5
M12	13	37	3.0
M14	15	44	3.0
M16	17	50	3.0
M18	20	56	4.0
M20	22	60	4.0

Spring Washers
(DIN127B)

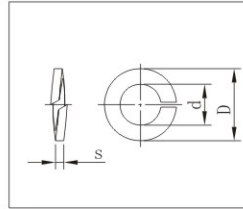

Size	d	D	s
M3	3.4	6.2	0.8
M4	4.4	7.6	0.9
M5	5.4	9.2	1.2
M6	6.5	11.8	1.6
M8	8.5	14.8	2.0
M10	10.7	18.1	2.2
M12	12.7	21.1	2.5
M14	14.7	24.1	3.0
M16	17	27.4	3.5
M18	19	29.4	3.5
M20	21.2	33.6	4.0
M22	23.5	35.9	4.0
M24	25.5	40	5.0
M27	28.5	43	5.0
M30	31.7	48.2	6.0

Spring Washers
(DIN7980)

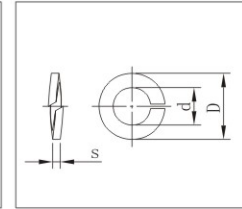

Size	d	D	s
M3	3.1	5.6	1.0
M4	4.1	7.0	1.2
M5	5.1	8.8	1.6
M6	6.1	9.9	1.6
M8	8.1	12.7	2.0
M10	10.2	16	2.5
M12	12.2	18	2.5
M14	14.2	21.1	3.0
M16	16.2	24.4	3.5
M18	18.2	26.4	3.5
M20	20.2	30.6	4.5
M22	22.5	32.9	4.5
M24	24.5	35.9	5.0

EPDM Washer

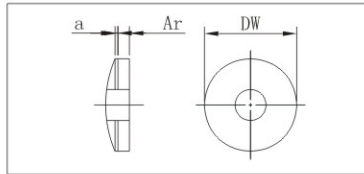

Specification	Specification	Specification
(2.0+0.5)×14	(2.5+0.5)×14	(2.5+0.8)×14
(2.0+0.5)×16	(2.5+0.5)×16	(2.5+0.8)×16
(2.0+0.5)×19	(2.5+0.5)×19	(2.5+0.8)×19

Long Link Chain DIN763

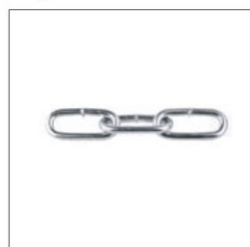
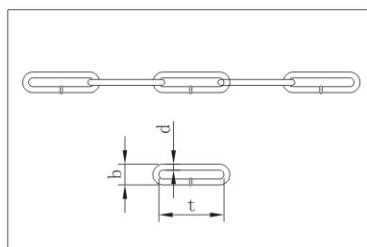

Specification	Specification
2MM	10MM
3MM	12MM
4MM	14MM
5MM	16MM
6MM	18MM
8MM	20MM

Hex Socket Pan Head Conformat Screw

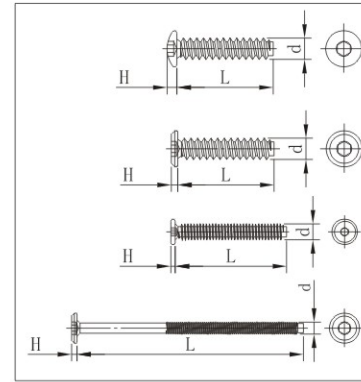

Specification	Specification
6×40	6×70
6×50	6×80
6×60	6×90

Internal And External Thread Nut

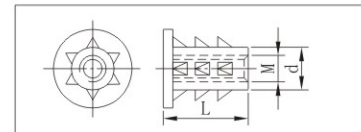

Specification	Specification	Specification
1/4"	M3	M6
5/16"	M4	M8
3/8"	M5	M10

Pozi Drive Conformat Screw

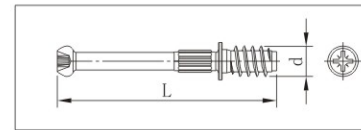

Specification	Specification
	6.3×34.1
	6.3×38.1
	6.3×44.1

Binding Screw

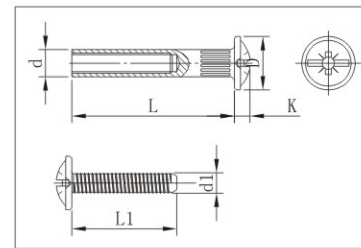

Specification	Specification
5×30	7.5×30
7.5×20	7.5×35
7.5×25	7.5×40

Carriage Bolt with Mushroom Head and Square Neck (DIN603)

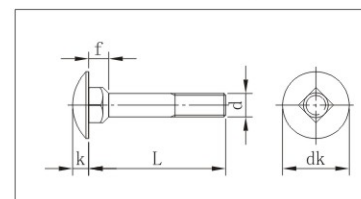

d	dK	K	f	L
M5	13.55	3.30	4.10	10-120
M6	16.55	3.88	4.60	10-230
M8	20.65	4.88	5.60	16-300
M10	24.65	5.38	6.60	20-300
M12	30.65	6.95	8.75	20-300
M16	38.80	8.95	12.90	30-300

FURNITURE ACCESSORIES

Zinc Alloy Easy Drive Anchors

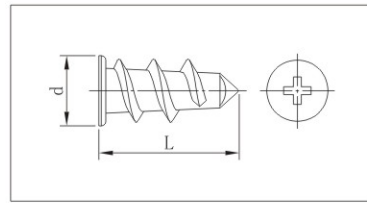

Size	d	L
14×28	14	28
14×38	14	38

"Z" Allen Key

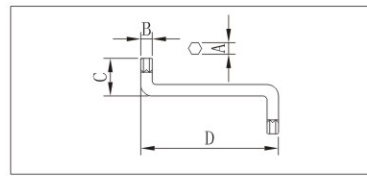

Specification	Specification
48×20 (SW4)	

"L" Allen Key

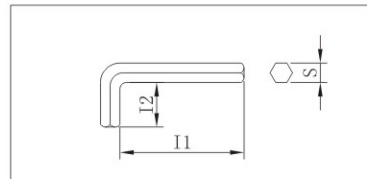

Specification	Specification
54×28 (SW2.5)	120×31 (SW5)
60×22 (SW3)	86×36 (SW6)
66×28 (SW4)	88×33 (SW8)
76×31 (SW5)	145×33 (SW8)

Hammer Nuts

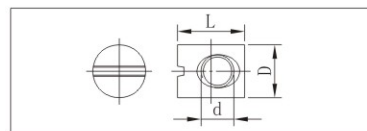

Specification	Specification
	M6×10×13
	M6×10×16
	M6×10×20

Shelf Support

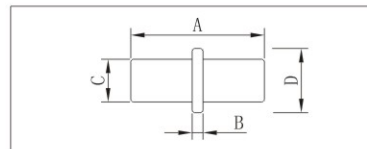

Specification	Specification
5mm	8mm
6mm	9mm

T Nut With 4 Claws

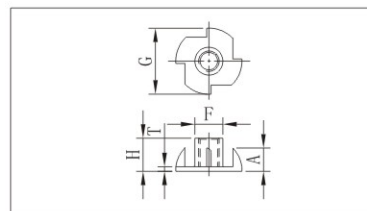

Specification	Specification
M4×8	M6×15
M5×8	M8×11
M6×9	M10×13
M6×10	M12×14

EXPANSION ANCHOR

- 3 Pcs Heavy Duty Shell Anchors
- 3 Pcs Heavy Duty Shell Anchors With Hex Bolt (G4.8)
- 3 Pcs Heavy Duty Shell Anchors With C Hook Bolt
- 3 Pcs Heavy Duty Shell Anchors With O Hook Bolt

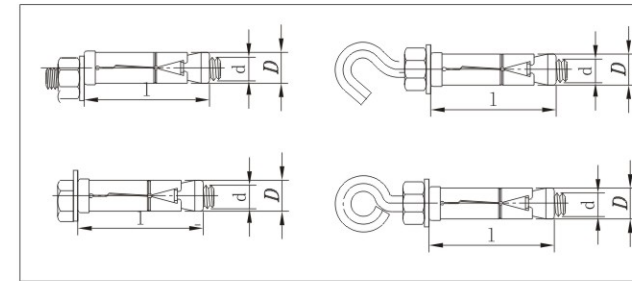

Size	d	D	l
M6	M6	12	45
M8	M8	14	50
M10	M10	16	60
M12	M12	20	75



- 4 Pcs Heavy Duty Shell Anchors
- 4 Pcs Heavy Duty Shell Anchors With Hex Bolt (G4.8)
- 4 Pcs Heavy Duty Shell Anchors With C Hook Bolt
- 4 Pcs Heavy Duty Shell Anchors With O Hook Bolt

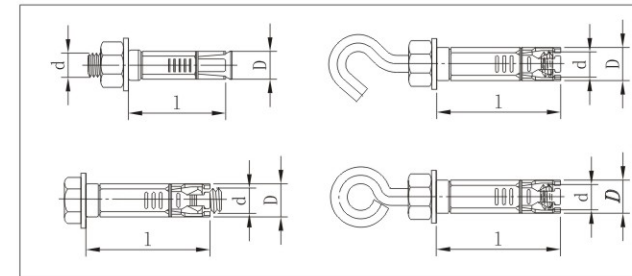

Size	d	D	l
M6	M6	10	40
M8	M8	14	50
M10	M10	16	60
M12	M12	20	80



EXPANSION ANCHOR

Sleeve Anchor With Hex Bolt
Sleeve Anchor With C, O Hook Bolt

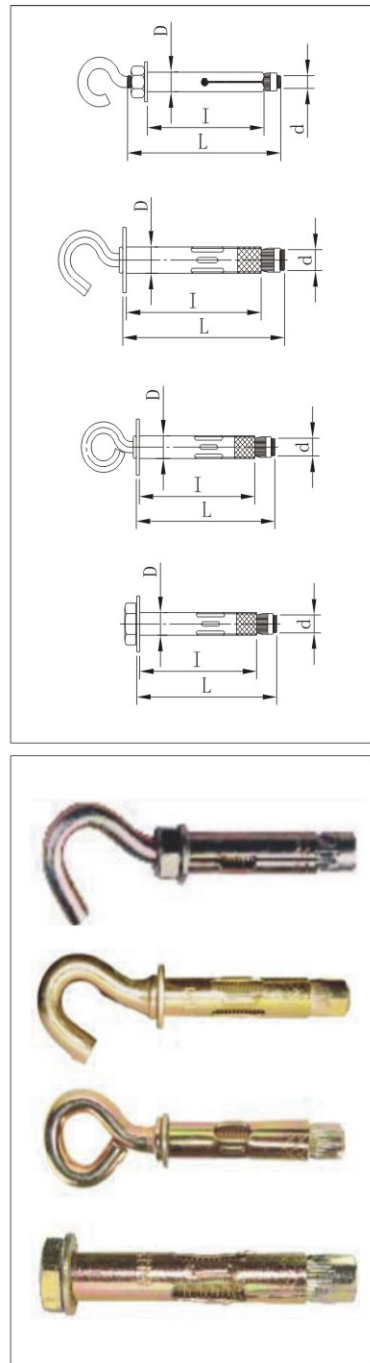

Size	d	D	L	I	Pull Out (kgf)	Fastener Material Thickness
8×40	M6	8	40	30	800	12
8×45	M6	8	45	34.5	800	17
8×60	M6	8	60	50	800	32
8×80	M6	8	80	70	800	52
8×85	M6	8	85	75	800	57
8×90	M6	8	90	80.3	800	62
8×100	M6	8	100	90.3	800	72
10×50	M8	10	50	36	1500	12
10×55	M8	10	55	41	1500	13
10×60	M8	10	60	46	1500	15
10×75	M8	10	75	61	1500	27
10×80	M8	10	80	66	1500	30
10×85	M8	10	85	71	1500	35
10×100	M8	10	100	86	1500	62
10×110	M8	10	110	96	1500	72
10×115	M8	10	115	101	1500	77
10×120	M8	10	120	106	1500	82
10×125	M8	10	125	111	1500	87
10×130	M8	10	130	116	1500	92
10×140	M8	10	140	124.9	1500	102
12*65	M10	12	65	48	2500	20
12*70	M10	12	70	53.5	2500	25
12*80	M10	12	80	63.5	2500	30
12*100	M10	12	100	83.5	2500	51
12*110	M10	12	110	93.5	2500	61
12*120	M10	12	120	103.5	2500	71
12*140	M10	12	140	123.5	2500	91
12*150	M10	12	150	133.5	2500	101
16*80	M12	16	80	63	3700	35
16*110	M12	16	110	93	3700	65
16*130	M12	16	130	113	3700	85
16*150	M12	16	150	133	3700	105

EXPANSION ANCHOR

Hollow Wall Anchors

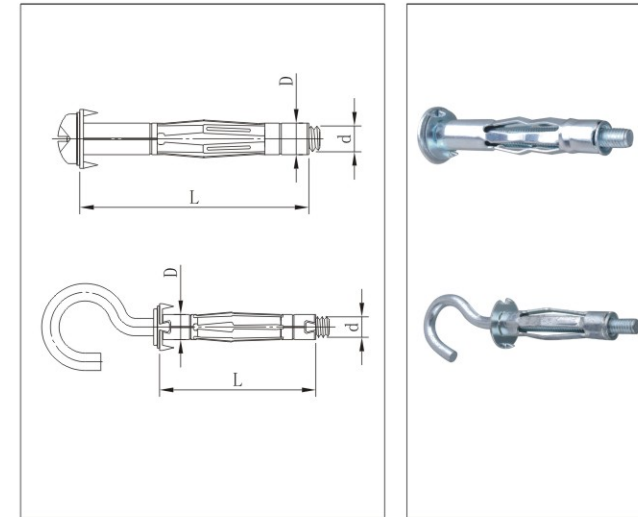

Size	d	D	L
M4X20	M4	7	20
M4X25	M4	7	25
M4X32	M4	7	32
M4X38	M4	7	38
M4X46	M4	7	46
M4X54	M4	7	54
M4X59	M4	7	59
M5X37	M5	9	37
M5X45	M5	9	45
M5X52	M5	9	52
M5X65	M5	9	65
M5X80	M5	9	80
M6X37	M6	11	37
M6X45	M6	11	45
M6X52	M6	11	52
M6X65	M6	11	65
M6X80	M6	11	80

Expanding Heavy Duty One Shield Anchor

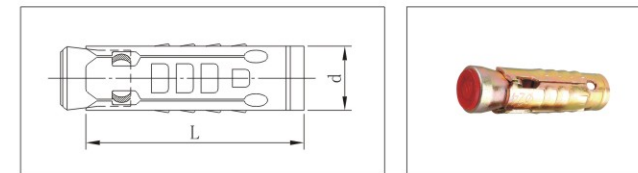

Specification	M6
	M8
	M10
	M12
	M20

Nylon Hammer Drive Anchors

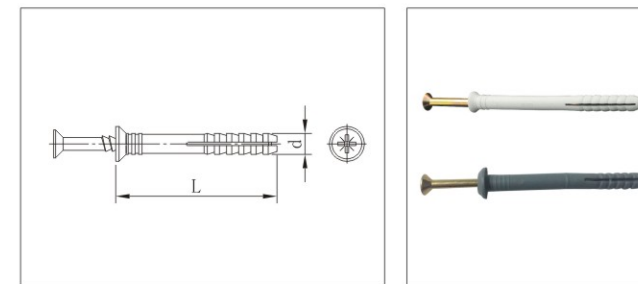

Size	d	L
5X30	5	30
6X40	6	40
6X60	6	60
8X80	8	80
8X100	8	100
10X100	10	100
10X120	10	120
10X140	10	140
10X160	10	160

Gravity/Spring Toggle Anchors

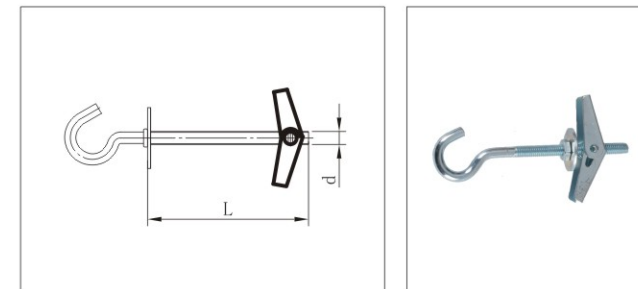

Size	d	L	Drill Dia
M4X75	M4	75	12
M4X90	M4	90	12
M4X100	M4	100	12
M5X75	M5	75	15
M5X90	M5	90	15
M5X100	M5	100	15
M6X75	M6	75	17
M6X90	M6	90	17
M6X100	M6	100	17

EXPANSION ANCHOR

Hit Anchors

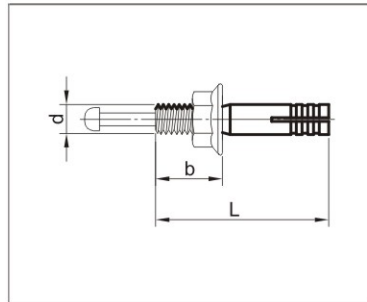

Size	d	L	b	Pull Out (Kgs)
M6X40	M6	40	15	450
M6X50	M6	50	20	450
M6X60	M6	60	20	450
M8X50	M8	50	20	900
M8X60	M8	60	20	900
M8X70	M8	70	25	900
M10X50	M10	50	20	1300
M10X60	M10	60	20	1300
M10X70	M10	70	25	1300
M10X80	M10	80	25	1300
M10X90	M10	90	25	1300
M10X100	M10	100	30	1300
M10X120	M10	120	30	1300
M12X80	M12	80	30	1600
M12X90	M12	90	30	1600
M12X100	M12	100	30	1600
M12X120	M12	120	50	1600
M16X100	M16	100	40	2600
M16X150	M16	150	40	2600
M20X150	M20	150	50	3000
M20X190	M20	190	50	3000

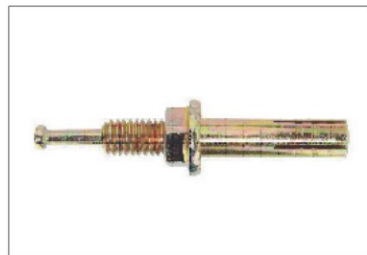

Bolt Anchors

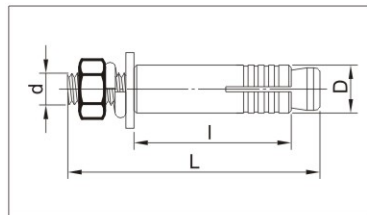

Size	d	L	D	I	Pull Out (Kgs)
1/4"X50	1/4"-20	50	9.5	30	890
5/16"X65	5/16"-18	65	12	35	1390
3/8"X75	3/8"-16	75	14	40	1600
1/2"X100	1/2"-13	100	16.6	50	2540
5/8"X100	5/8"-11	100	21.7	50	3300
5/8"X125	5/8"-11	125	21.7	60	3300
3/4"X160	3/4"-10	160	25.4	80	4950



Drop In Anchors

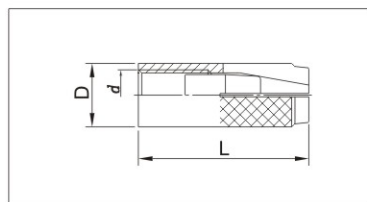

Size	d	D	L	Pull Out (Kgs)
M6	M6	8	25	950
M8	M8	10	30	1350
M10	M10	12	40	1950
M12	M12	16	50	2900
M16	M16	20	65	4850
M20	M20	25	80	5900



Sleeve Anchor With DIN7991 Countersunk Bolt

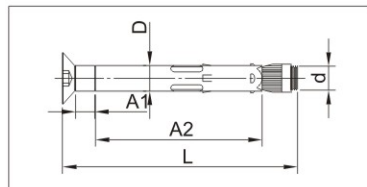

Specification
M8 X 10 X 60
M8 X 10 X 80
M10 X 12 X 100



Eye Hook BoIt With Metric Thread

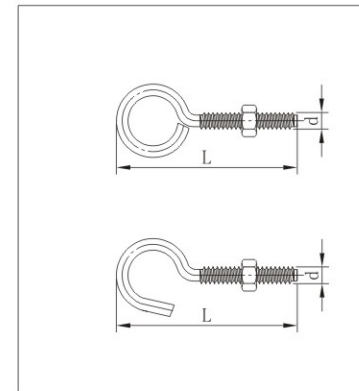

Specification	Specification	Specification
1/4"-20/1-7/8"	1/4"-20/1-7/8"	5/16"-18/2-1/2"
1/4"-20/2"	1/4"-20/2"	5/16"-18/3-1/2"
1/4"-20/3"	1/4"-20/3"	5/16"-18/4-1/2"
1/4"-20/4"	1/4"-20/4"	7/16"-14/6"
1/4"-20/5"	1/4"-20/5"	1/2"-13/1-3/4"
1/4"-20/6"	1/4"-20/6"	1/2"-13/3-3/4"
5/16"-18/3/4"	5/16"-18/3/4"	1/2"-13/7-3/4"
5/16"-18/1-3/4"	5/16"-18/1-3/4"	1/2"-13/9-3/4"
5/16"-18/2-1/8"	5/16"-18/2-1/8"	

Hex Head Heavy Duty concrete Screw/Hex Flange Head Concrete Screw

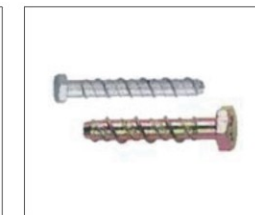
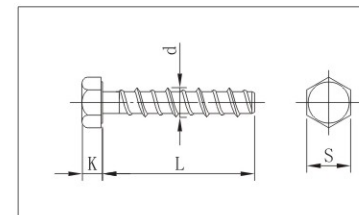

Size	ThreadLength (mm)	Size	ThreadLength (mm)
6.5x50	41	12x100	92
6.5x75	66	12x210	120
8.0x60	52	12x310	120
8.0x100	80	14x115	107
10x120	100	14x160	120
10x200	100	16x150	142
12x75	67	16x280	150

Square Hook Roofing Bolt

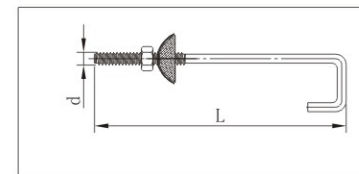

Specification
M5x4"-10"
M6x4"-10"
M8x4"-10"
1/4x4"-10"

Concrete Screws T30 or T25

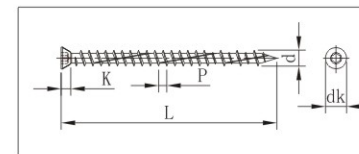

Size	d	dk	k	p	L
7.5x52	7.5	11	3.4	2.6	52
7.5x62	7.5	11	3.4	2.6	62
7.5x82	7.5	11	3.4	2.6	82
7.5x102	7.5	11	3.4	2.6	102
7.5x122	7.5	11	3.4	2.6	122
7.5x152	7.5	11	3.4	2.6	152
7.5x172	7.5	11	3.4	2.6	172
7.5x182	7.5	11	3.4	2.6	182
7.5x192	7.5	11	3.4	2.6	192
7.5x202	7.5	11	3.4	2.6	202
7.5x212	7.5	11	3.4	2.6	212

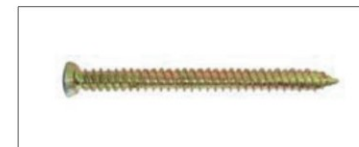

EXPANSION ANCHOR

J type Hook Roofing Bolt

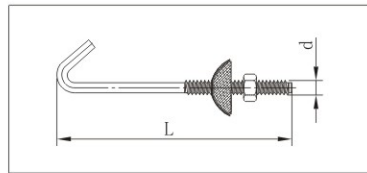

Specification	M5×2"-10"
	M6×2"-10"
	M8×2"-10"
	1/4×2"-10"

Sleeve Anchor With Flange Nut
Sleeve Anchor With Hex Nut

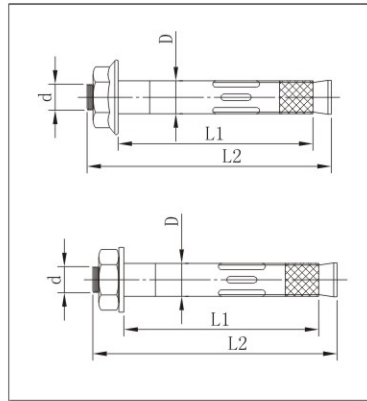

Size	d	D	L1	L2	Fastener Material Thickness
8×40	M6	8	34.5	47.1	12
8×70	M6	8	64.5	77	42
8×90	M6	8	84.5	97	62
8×120	M8	10	114.5	127	92
8×140	M8	10	135.3	147	112
10×50	M8	10	43.3	58.2	12
10×60	M8	10	53	67.9	15
10×70	M8	10	63	77.9	33
10×90	M8	10	112.9	128	82
10×120	M8	10	112.9	128	82
10×130	M8	10	122.9	138	92
10×150	M8	10	142.9	159	112
12×150	M10	12	141	160	102
12×80	M10	12	71	89.4	32
12×150	M10	12	141	160	102
12×180	M10	12	171	189	132
16×65	M12	16	55	76.4	20
16×85	M12	16	75	98.4	40
16×111	M12	16	101.6	125	65
16×147	M12	16	136.4	159.8	102
16×165	M12	16	155	178.4	120
16×180	M12	16	169.4	193	135
16×220	M12	16	206.4	230	175
20×75	M16	20	64	90.9	25
20×107	M16	20	97	123.9	57
20×151	M16	20	141	165	101
20×161	M16	20	151	175	111
20×180	M16	20	170	195	130
20×200	M16	20	189	215	150

Metal Frame Anchors Hollow Metal Frame Anchor

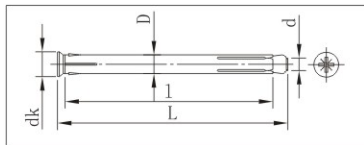

Size	D	d	dk	l	L
8×72	8	M5	10.2	72	82
8×92	8	M5	10.2	90	102
8×132	8	M5	10.2	132	142
10×72	10	M6	13.2	72	82
10×92	10	M6	13.2	92	102
10×112	10	M6	13.2	112	122
10×132	10	M6	13.2	132	142
10×152	10	M6	13.2	152	162
10×182	10	M6	13.2	182	192
10×202	10	M6	13.2	202	212

Wedge Anchors
Wedge Anchors(304 stainless steel ring)

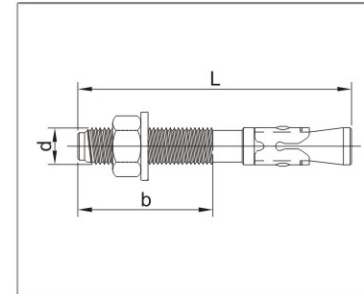

Size	d	L	b	Max Fast Thickness	Pull Out (Kgs)
M6X40	M6	40	16	3	850
M6X55	M6	55	25	15	850
M6X70	M6	70	30	30	850
M6X95	M6	95	50	55	850
M8X50	M8	50	20	10	1150
M8X65	M8	65	30	20	1150
M8X80	M8	85	40	35	1150
M8X95	M8	95	50	50	1150
M8X105	M8	105	50	60	1150
M8X120	M8	120	60	75	1150
M8X165	M8	165	100	135	1150
M8X220	M8	220	100	175	1150
M10X65	M10	65	25	15	1500
M10X80	M10	80	40	20	1500
M10X95	M10	95	45	35	1500
M10X115	M10	115	55	55	1500
M10X120	M10	120	60	60	1500
M10X130	M10	130	65	70	1500
M12X80	M12	80	35	20	2300
M12X100	M12	100	50	30	2300
M12X120	M12	120	50	50	2300
M12X135	M12	135	70	65	2300
M12X150	M12	150	80	80	2300
M16X105	M16	105	50	15	3400
M16X140	M16	140	60	40	3400
M16X180	M16	180	75	80	3400
M16X220	M16	220	100	120	3400
M20X125	M20	125	50	15	5400
M20X160	M20	160	75	40	5400
M20X200	M20	200	100	80	5400
M20X300	M20	300	170	180	5400





EXPANSION ANCHOR

Zinc Alloy Hammer Drive Anchors

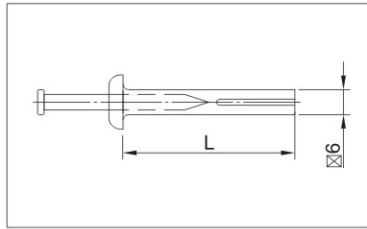

Size	L	Pull Out Kgs
6× 30	30	330
6× 40	40	370
6× 50	50	430
6× 65	65	430

Zinc Alloy Anchor

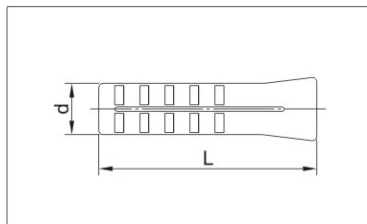

Specification	Specification
6-8× 3/4"	10-14-1"
6-8× 1"	10-14× 1-1/2"
6-8× 1-1/2"	16-18× 1"
10-14-3/4 "	16-18× 1-1/2"

Ceiling Anchors

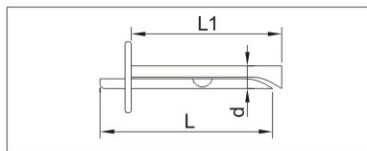

Size	d	L	L1	Max Fast Thickness
6X40	6	40	36	5
6X60	6	60	55	35

Zinc Alloy Single Head Anchor

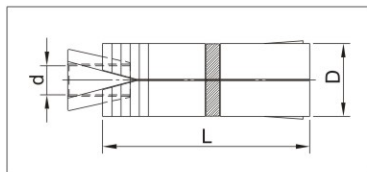

Specification	Specification
	3/16"
	1/4"
	5/16"
	3/8"
	1/2"

Zinc Alloy Double Head Anchor

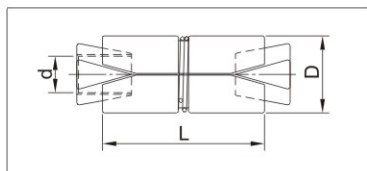

Specification	Specification
	5/16"
	3/8"

EXPANSION ANCHOR

Zinc Alloy Wooden Anchor

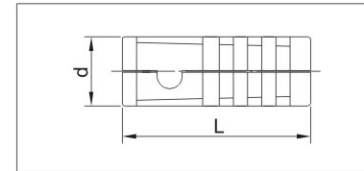

Specification	Specification
1/4L	3/8L
1/4S	3/8S
5/16L	1/2L
5/16S	1/2S

Big Washer Bolt Anchor

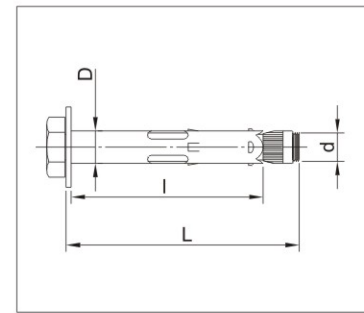

Specification	Specification	Specification
M6× 8× 45	M8× 10× 100	M10× 12× 140
M6× 8× 70	M8× 10× 120	M10× 14× 70
M6× 8× 90	M10× 12× 65	M10× 14× 100
M8× 10× 55	M8× 12× 80	M12× 16× 75
M8× 10× 80	M8× 12× 100	M12× 16× 110

Universal Metal Plugs / Saw Anchor

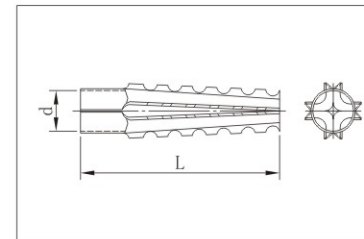

Size	d	L
5×30	5	30
6×32	6	32
8×38	8	38
8×60	8	60
10×60	10	60

Copper Drop In Anchor

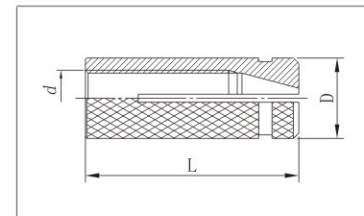

Specification	Specification	Specification
M4×5.5×15	M8×10×30	M12×15×40
M5×6.5×22	M10×12×32	M12×16×38
M6×8×24	M10×12×35	M16×18×45

Tie Wire Anchor

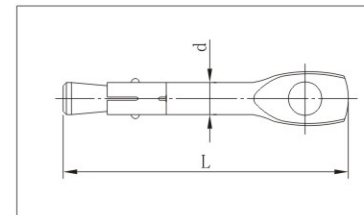

Specification	Specification
6×40	6×50
6×55	6×60
6×65	



TOGGLE FASTENERS

Eye Bolt (DIN580)		Ring Nut (DIN582)		Turnbuckle (DIN1480)		S Hook	
Specification	Specification	Specification	Specification	Specification	Specification	Specification	Specification
M6	M16	M6	M16	M5×70	M14×140	3MM	7MM
M8	M20	M8	M20	M6×110	M16×170	4MM	8MM
M10	M24	M10	M24	M8×110	M20×200	5MM	10MM
M12	M30	M12	M30	M10×125	M22×220	6MM	12MM
M14	M36	M14	M36	M12×125	M24×255		

Hose Clamp

		Specification	Specification
		16-25MM	44-64MM
		25-38MM	76-92MM
		32-44MM	80-100MM
		35-51MM	110-130MM

Single/Double Hose Clamp

		Specification	Specification
		C-SWR2b	C-SWR6b
		C-SWR3b	C-SWR8b
		C-SWR4b	C-SWR10b
		C-SWR5b	

TOGGLE FASTENERS

Short Link Chain (DIN766)	Wire Rope Clip (DIN741)	Straight Shackle	Pipe Clamp

Specification	Specification	Specification	Specification	Specification	Specification	Specification	Specification
2MM	12MM	3MM	16MM	5MM	18MM	15-18MM	75-80MM
3MM	14MM	5MM	20MM	6MM	20MM	20-24MM	106-112MM
4MM	16MM	6MM	22MM	8MM	22MM	26-30MM	133-140MM
5MM	18MM	8MM	24MM	10MM	25MM	32-36MM	159-165MM
6MM	23MM	10MM	26MM	12MM	28MM	38-42MM	
8MM	26MM	12MM	30MM	14MM	32MM	51-55MM	
10MM	28MM	14MM	34MM	16MM		60-64MM	

Rotating Ring 401



Rotating Ring 402



Rotating Ring 403



Specification	1/4"	5/16"	3/8"	1/2"	5/8"
Specification	7/8"		1"		



TOGGLE FASTENERS

Steel Wire Rope
DIN3055



Specification	Specification
2MM	8MM
3MM	10MM
4MM	12MM
5MM	13MM
6MM	16MM

Steel Wire Rope DIN3055
With Pvc



Specification	Specification
2MM	8MM
3MM	10MM
4MM	12MM
5MM	13MM
6MM	16MM

Thimble
DIN6899A/DIN6899B



Specification	Specification
4	12
5	14
6	16
8	18
10	20

Snap Hook
DIN5299D



Specification	Specification
4×40	9×90
5×50	10×100
6×60	11×120
7×70	12×140
8×80	13×160

Oval Aluminum Cover
DIN3093



Specification	Specification
7MM	18MM
11MM	22MM
14MM	28MM

Quick Link



Specification	Specification
3.5MM	8MM
4MM	10MM
5MM	12MM
6MM	14MM
7MM	16MM

Lift Hook

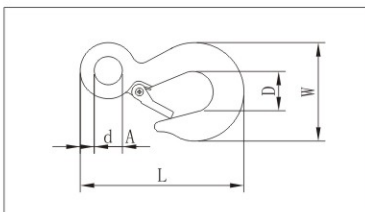

Specification	Specification
0.75	3.2
1.0	5.0
1.5	7.0
2.0	11

TOGGLE FASTENERS

Lift Hook
DIN689



Specification	Specification
250	4000
500	5000
1000	6300
2500	
3200	

Electro Galvanized Chain Card



Specification	Specification
M6	M16
M8	M20
M10	M24
M12	M30
M14	

Single Spring Wheel



Specification	Specification
M15	M50
M20	M75
M25	M100
M32	

G80 Welded Rotating Hook

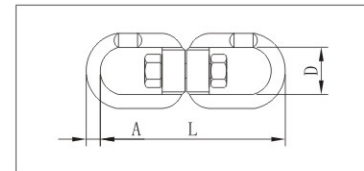

Specification	7/8"
	10
	13
	16

Weldless Round Ring

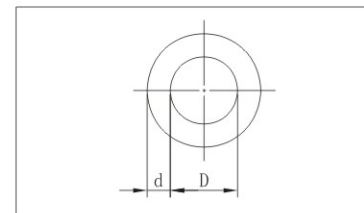

Specification	Specification
20	38
24	45
28	52
33	58

G80 Omega Link

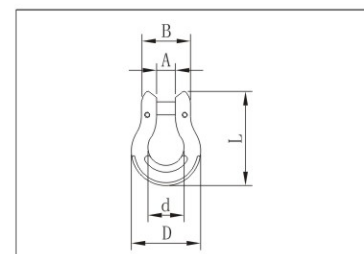

Specification	7/8"
	6
	10
	13
	16
	20

RIVETS

Open type round head core pulling rivet DIN7337

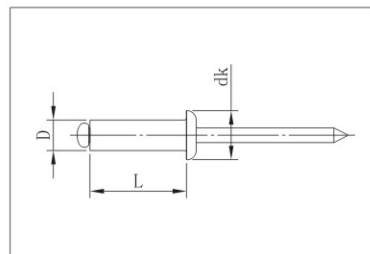

D	dK	L
2.4	5.0	6-50
3.0	6.5	6-50
3.2	6.5	6-50
4.0	8.0	6-50
4.8	9.5	6-50
5.0	9.5	6-50
6.0	12.0	6-50
6.4	13.0	6-50

Open type countersunk head core rivet DIN7337

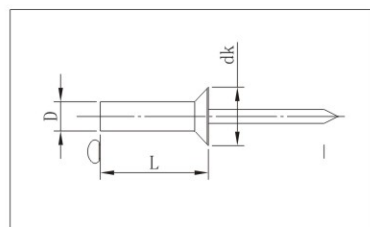

D	dK	L
3.0	6.0	6-50
3.2	6.0	6-50
4.0	7.5	6-50
4.8	9.0	6-50
5.0	9.0	6-50
6.0	11.0	6-50
6.4	12.0	6-50

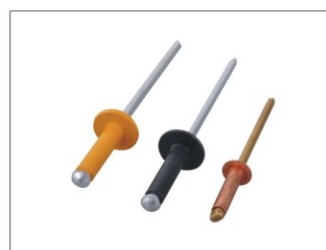

STEEL CORNER & SHELF BRACKETS

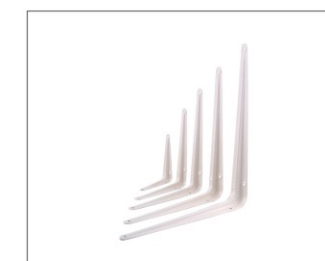
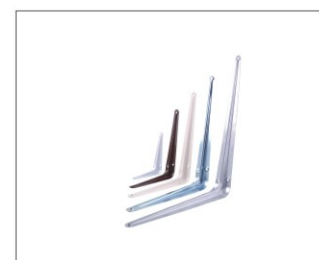
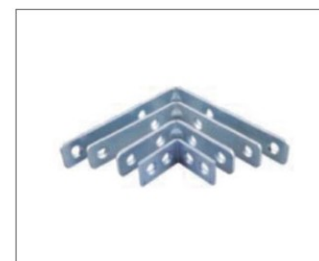



STAINLESS STEEL PRODUCTS



QUALITY CONTROL TESTING TOOLS DO EACH LOT INSPECTION BEFORE SHIPMENT!





HARDWARE TOOLS & WASHERS



FURNITURE ACCESSORIES

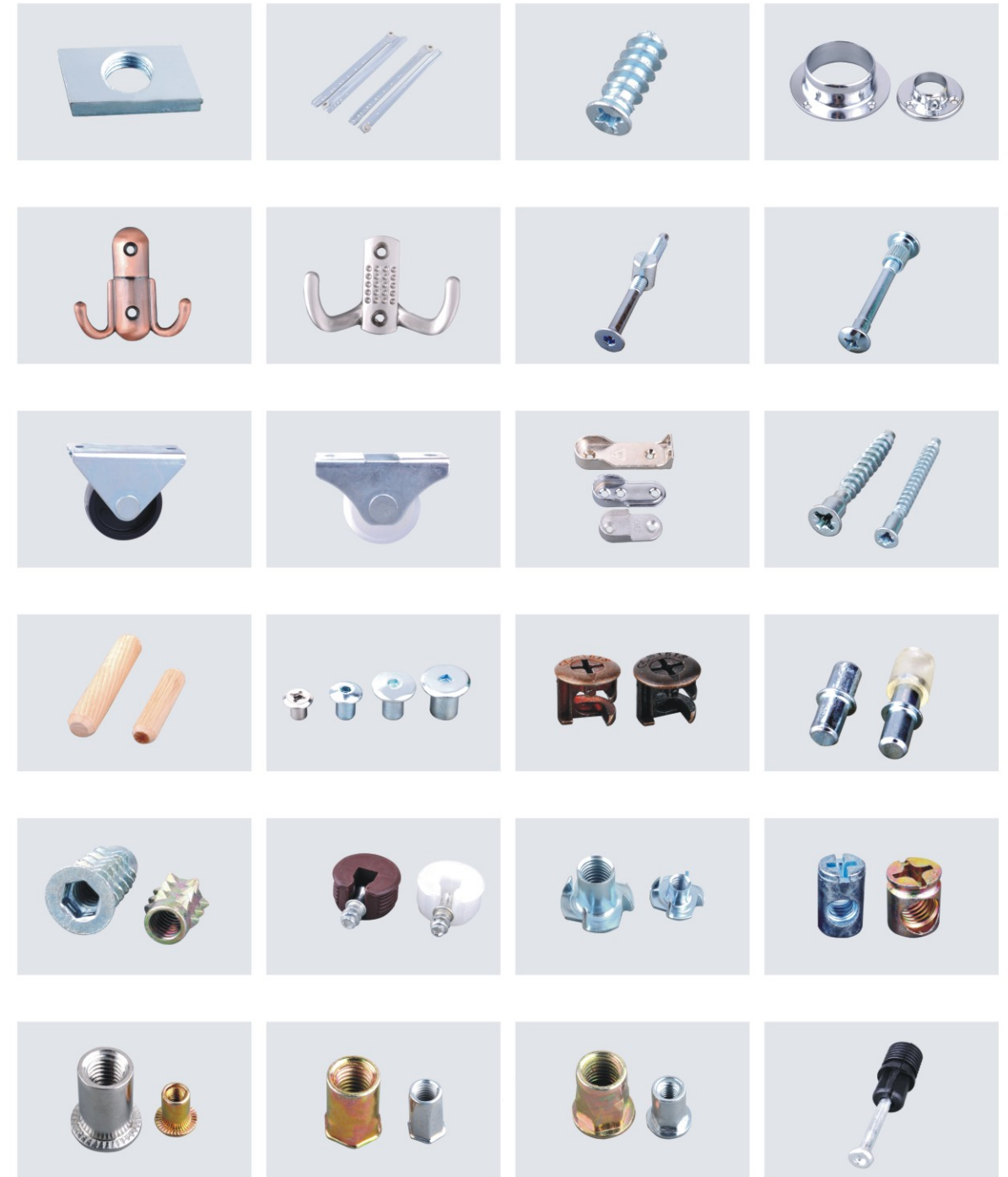



NYLON & PLASTIC PRODUCTS



NON-STANDARD PRODUCTS

